

DUNE NOMAD COMPACT ROOF TOP TENT

Instruction

CONTENTS

Before using this product, please follow the instruction manual to ensure proper use.

Products Brief Instruction:

1.Product Brief Instruction-----	1
2.Product Specification-----	1
3.Product Frame-----	1

Installation

1.Installing Your Roof Tent-----	2
2.Setting up-----	4
3.Folding down-----	6

Safety Infomation-----	8
------------------------	---

Products brief instruction:

This Lite Cruiser roof tent could be set up easily by 1 person, set up and fold down in seconds by telescopic ladder. keep you safe and comfortable, enjoy the outdoors where your vehicles arrive in different weather.

Products specification:

- A. The whole frame uses aluminium alloy, parts of joints are made of strong nylon.
- B. Double layer silver coating treatment for outer tent material to offer better heat insulation and waterproof.
- C. 3" foam mattress provides comfortable sleep experience
- D. Telescopic aluminum alloy ladder is removable and can endure 150kg.

Material:

Fly: 210D rip-stop oxford PU3000mm with silver coating, UPF50+

Inner: Durable 600D rip-stop oxford PU2000mm

Floor: 210D polyoxford PU2000mm

Cover: Durable 600D oxford with PVC coating, PU5000mm

Frame: Aluminum, Telescopic Alu. Ladder

Structure:

Size 130

Inner tent size: 212x130x95cm

Pack size: 147x121x36.5cm

Net weight:40kg include the ladder

Gross weight: 50kg

Product frame:

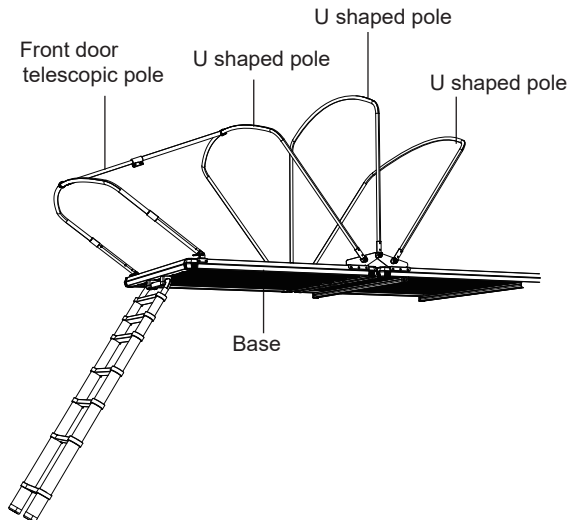

Main properties and characteristics

Easy handling, by simply pulling & pushing the ladder, the tent can be set up and folded down in few second.

Installation:

- ④ Lift up the tent onto the rack from car side, adjust the tent to the roof center, ensuring the rear door can be opened/closed.

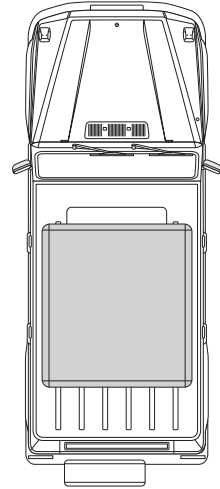
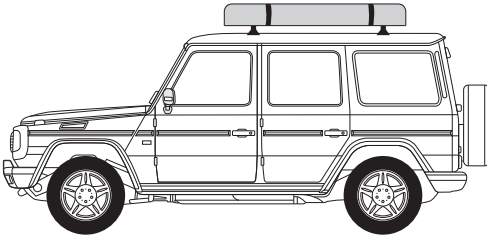

- ⑤ Slide the T shape bolts into the rails from two sides(as P1).

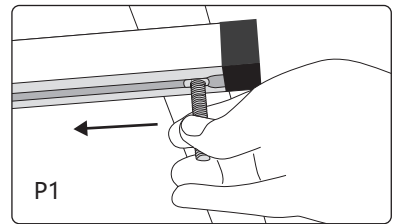

- ⑥ Slide T shape bolts into the middle hole of rail, with U-Shape Stator, M8 Arc Washer, M8 Flat Washer, and Plastic Nut lightly screwed in advance.(as P2)

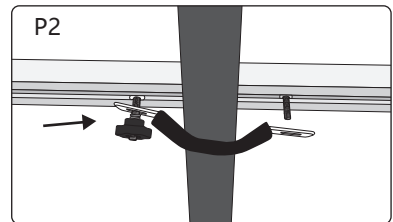
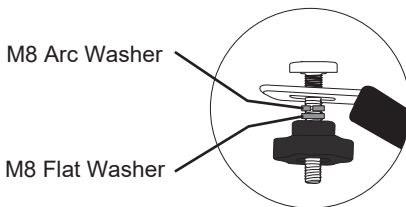

- ⑦ Screw the other side of U Shaped Stator with component in order as above, and ensure Stator tightened(as P3, same operation for rest).

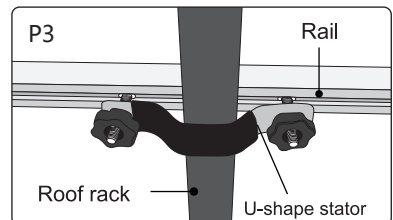

INCLUDED TOOLS:



U Shape Stator(4pcs)

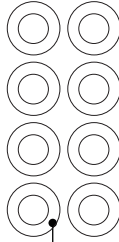

M8 Flat Washer(8pcs)

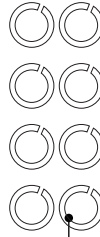

M8 Arc Washer(8pcs)

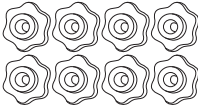

Plastic Nut(8pcs)

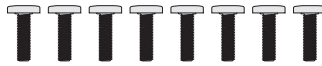

T shape bolts(8pcs)

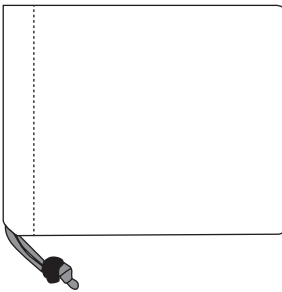

Tool Bag



M8*35mm
T shape bolts(8pcs)



6mm Hex Key(1pc)

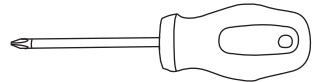

Cross Screwdriver(1pc)

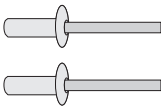

Aluminum Rivet(2pcs)



8-10mm open end wrench(1pc)

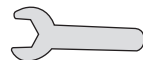

14mm open end wrench(1pc)

Setting up:

- ① Release all buckles around the cover then remove it.

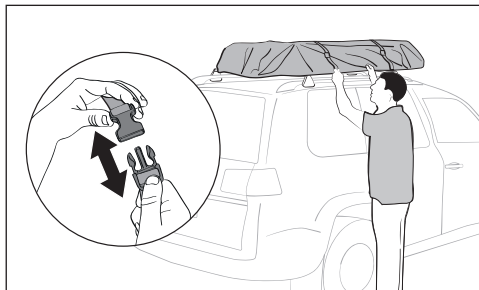

- ② Release the buckle of ladder, then fully extend the ladder.

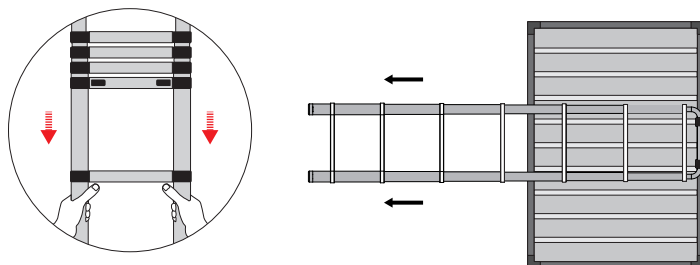

- ③ Hold the bottom of the ladder as a lever to press down and turn over the tent, then adjust the length of ladder.

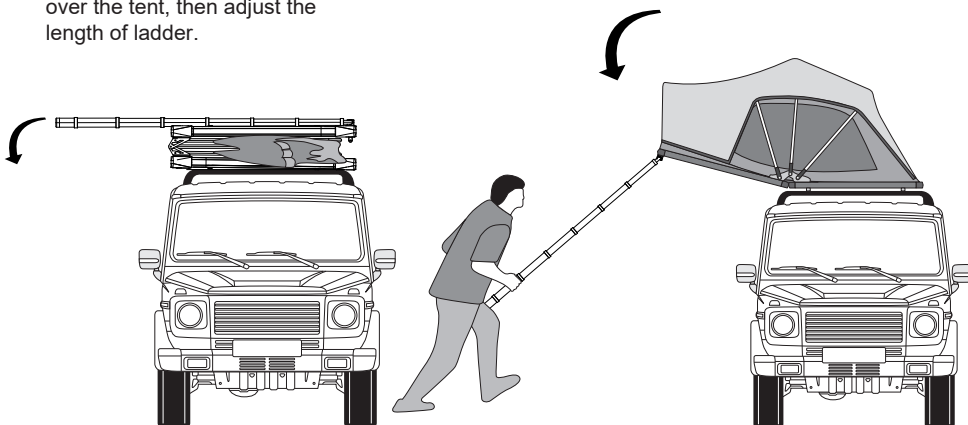

Setting up:

- ④ Press the porch buttons on both sides, pull out the telescopic pole on two sides of the porch.

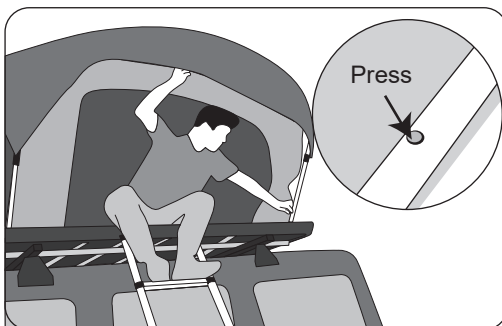

- ⑤ Lock the pole inside the top of porch, then set up finished.

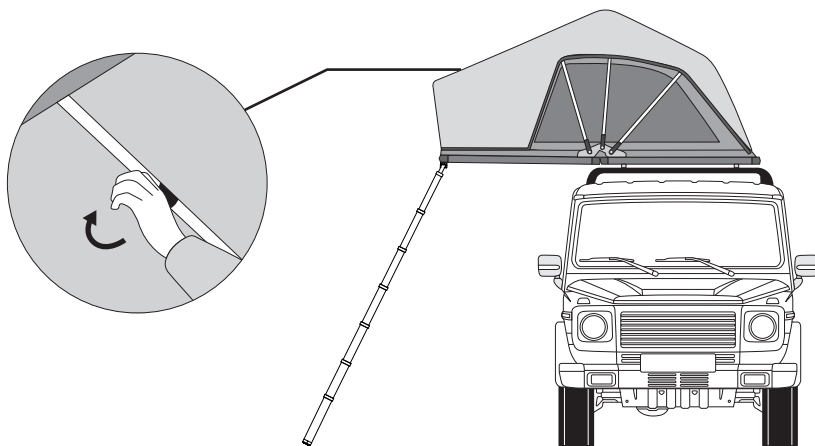

Folding down:

① Close all windows. Hook the elastic ropes inside the tent(as P1).
Unlock the pole inside the top of porch(as P2). Zip up the front door to two thirds position. Then push down the porch.

② Press the button on two sides of porch to shorten the front door telescopic pole(as P3). Tuck shoes bags(as P4).

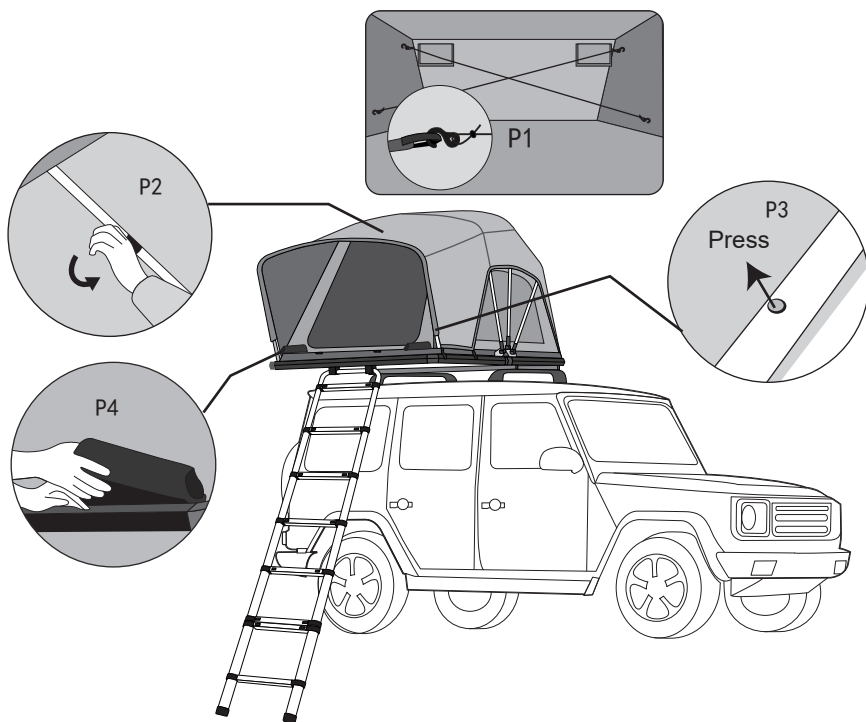

Folding down:

③ Lift the ladder upward to fold the tent. Ensure no fabric is exposed outside. Press the bottom button of ladder and push forward to shorten the ladder.

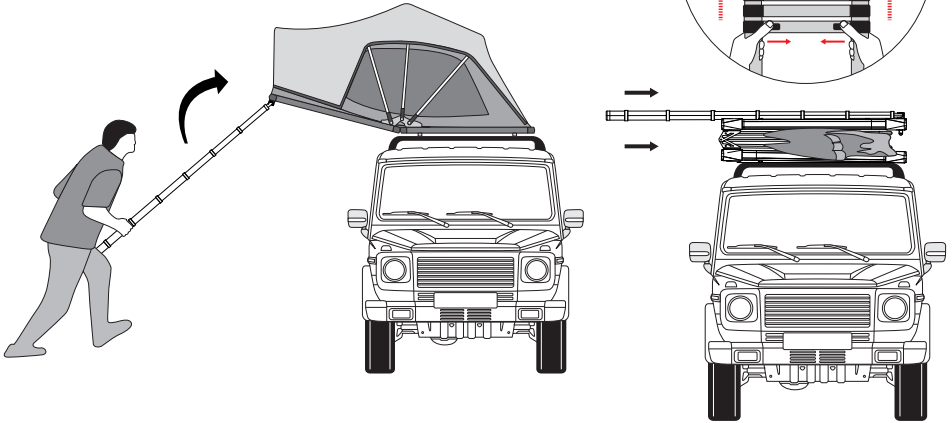

④ Secure the strap of tent, put cover on and fasten the buckles all around, then fold down finished.

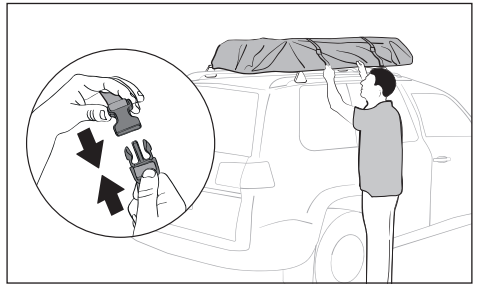
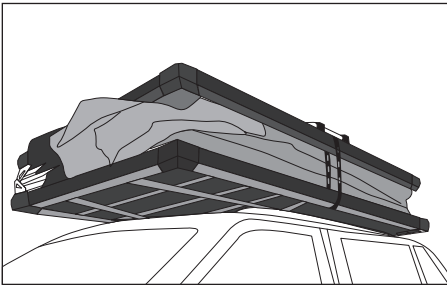

Trouble shooting:

If meet malfunction when roof tent setting up or folding down, please check:

- A. Whether bolts on pole screw tightly
- B. Whether the pole get stuck by fabric

Safety Information

- We recommend that you DO NOT drive over 70mph (110kmh) while using your rooftop tent and that you always adhere to speed limits.
- DO at the start of every journey and at regular intervals during every journey check that your roof tent is firmly fixed to your roof bars and that all of the locking straps are securely fastened. Only ever check your roof tent in a safe and suitable location.
- DO NOT use your roof tent if there is any visible damage to any part of it or its components, instead contact us to see how we can help. This is especially applicable to the locking straps and buckles.
- Understand that secured loads and incorrectly mounted roof bars can come lose during journeys and can cause serious accidents.
- Make sure that you give due consideration to the change in your vehicle height and drive behaviour (side-wind sensitivity, corner and braking behaviour).
- You must always consult your vehicle and roof bar manuals to ensure you are following their advice, these must be always be carried in your vehicle along with your roof tent safety and fitting instructions.
- Do not use bleach, alcohol or ammonia based cleaning liquids on your roof tent otherwise the surface of your roof tent may get damaged
- Please note the following when using your roof tent: –
 - The height of your vehicle can increase by up to 90cm (dependant on your roof bars).
 - Beware of low entrances, low hanging branches, etc.
 - Wind noise may be generated when travelling with a roof tent
 - When using an automatic car-wash facility, your roof tent must first be removed.

–In addition to these usage instructions, due consideration should also be given to mounting instructions for your roof bars and the operating instructions of your vehicle.

–For reasons of fuel economy and the safety of other road users, your roof tent and roof bars should be removed when not in use.

–For your safety, you should only use tested (e.g. GS–tested) roof bars that are authorised for usage in conjunction with your vehicle.

–In order to avoid generating excessive lifting forces, your roof tent should be mounted parallel to the line of the road and not at an angle

- When climbing in and out of your roof tent always use the ladder with due caution and never allow children to use it alone. Make sure the ladder hooks are in good condition, contact us if you need replacements.

- You must not allow any naked flames in or near your roof tent

Important Information

The manufacturer is not liable for any damage or accident that may occur as a result of non– compliance with these usage instructions, modifications made to parts or the usage of any parts other than the manufacturer’ s original parts. The warnings, cautions and instructions in this document can’ t cover every possible situation, so it is understood by the operator that common sense and caution must be applied. It is your responsibility to pass these instructions on to any third party who uses this roof tent, including second hand sales.

Warranty

The manufacturer’s warranty covers manufacturing faults and lasts one year within regular use. It is only valid if the instructions and recommendations in this document are adhered to and only applies to the first owner. Second hand sales are not covered.
