

COMPANION[®]

TRUSTED SINCE 1941

AQUACUBE[®] 12V

DIGITAL CAMP SHOWER



OWNERS MANUAL

Part No. COMP812AN



IMPORTANT. Read these instructions for use carefully. Familiarise yourself with the appliance before connecting it to its gas container. Keep these instructions for future reference.

THIS APPLIANCE IS NOT INTENDED FOR THE SUPPLY OF DRINKING WATER

This appliance is intended for the supply of heated water for the purpose of washing and cleaning only. Check and confirm safe water temperature before using this appliance. Water from this appliance may be very hot.

GENERAL WARNINGS

This appliance is designed to be used with a source water temperature of 20°C or below.

The maximum temperature lift from the appliance is 30°C from the source water temperature.

For safety the appliance is designed to shut off the burner when the water temperature from the outlet reaches 50°C.

This appliance shall only be used with the regulator supplied with the appliance and must only be connected to non-refillable disposable propane cartridges certified to DOT-39, UN1075.

IT MAY BE HAZARDOUS TO ATTEMPT TO FIT OTHER TYPES OF GAS CONTAINERS.

This appliance is to be stored in a dry and well ventilated location free from direct sunlight.

Do not store when still connected to the cartridge. Make sure that the cartridge is disconnected and is stored in a well ventilated area, free from direct sunlight, heat and ignition sources. If being stored indoors ensure that the location complies with the standard AS/NZS1596.

This appliance must only be serviced by an authorised service agent, return to your place of purchase for service and repair.

Do not:

Operate this appliance before reading this instruction booklet.

Place articles on or against this appliance.

Place chemicals or flammable material, or spray aerosols near this appliance.

Operate panels, covers or guards removed from this appliance.

Operate in an enclosed area without ventilation.

Operate in a boat, caravan or tent.

ONLY USE IN WELL-VENTILATED AREAS.

CARBON MONOXIDE HAZARD



USING THIS APPLIANCE IN AN ENCLOSED SPACE MAY CAUSE DEATH. DO NOT USE IN CARAVANS, TENTS, MARINE CRAFT, CARS, MOBILE HOMES OR SIMILAR LOCATIONS.

USE OUTDOORS ONLY.

CAUTION: accessible parts may be very hot. Keep young children away.

SAFETY INFORMATION

Ensure all packaging is removed prior to first use.

This appliance is designed for outdoor use only.

Do not use the appliance if it has a leak, worn, deteriorated or damaged seals.

Handle with care even after brief use, always pick up using the handle not the cartridge.

It may be hazardous to attempt to fit other types of gas containers or cartridges.

Use only in well ventilated areas.

This appliance shall only be used in an above ground open air situation with natural ventilation, without stagnant areas, where gas leakage and products of combustion are rapidly dispersed by wind and natural convection.

Do not use adaptors or modify appliance to fit other connectors or cylinders.

When using this appliance children must be supervised by an adult at all times.

Never leave appliance unattended when operating.

Do not use as a cooking appliance or modify for any other reason.

OUTDOOR USE ONLY - The appliance must be used outdoors only and is to be operated no closer than 1000 mm from the sides and 1000 mm from above all combustible surfaces, fabrics and flammable materials.

Appliance is to be used on solid and stable horizontal surfaces made from non-combustible or non-flammable materials and should be protected from direct drafts and in a well ventilated place.

Keep away from children at all times.

Caution: Accessible parts may be very hot. Please take care when handling or moving the appliance.

If you smell gas immediately turn the power off and move the appliance and cartridge to a well ventilated area outside, keeping well away from sources of heat such as naked flames and pilot lights.

Do not attempt to move or relocate the appliance when it is operating. Extinguish the burner and allow to cool, disengage the gas cartridge then move the appliance.

Must be used with approved gas regulator supplied with the appliance. Do not use adaptors.

CHECKING FOR GAS LEAKS

Check that all connections are tight and that the gas cartridge connection has been tightened before you turn the appliance on.

Never check for leaks with a flame or pilot light.

Using soapy water coat all connections. If bubbles appear tighten the connection before re-testing.

This appliance must only be serviced by an authorised person.

Inspect the appliance regularly for signs of wear, leaks or incorrect operation. If symptoms such as flaring of the burners, issues with lighting, damage to connections or leaks from seals or gas controls are identified do not attempt to repair, return to your authorised stockist for service and maintenance.

To check if gas remains in the cartridge, disconnect from the appliance and hold the cartridge in a vertical position then shake from side to side. If there is a sound or a feel of liquid movement inside the cartridge, the cartridge contains gas.

When changing gas cartridges ensure this is conducted outside in a well ventilated location free from people, animals and ignition sources such as naked flames, pilot lights and electrical equipment with heaters or elements.

Check that the seals between the appliance and the gas container are in place and in good condition before connecting the gas container. Do not use this appliance if it has damaged or worn seals.

Do not use this appliance if it is leaking, damaged or does not operate properly.

IMPORTANT

This appliance is designed to be used with a source water temperature of 20°C or below, if the temperature of the outlet water exceeds 50°C the burners will shut off and will only relight once the outlet water temperature falls below 45°C.

This appliance is designed to raise the outlet water temperature by a maximum (average) of 30°C above the source water temperature and can be adjusted by the gas control. In the event that the temperature lift is insufficient, simply run water through the appliance once returning the heated water to the source water reservoir. Run again through the appliance until the desired temperature is reached.

SAFETY FEATURES

This appliance is equipped with the following safety features:

Over temperature sensor

The appliance will not allow the burner to remain in operation once the outlet water temperature reaches 50°C, the burner will automatically relight once the outlet temperature falls below 45°C.

Water flow sensor

Water must be flowing through the system to allow the burner to ignite. In the case that the water supply is restricted or ceases (i.e. the flow switch is in the off position), the burner will be extinguished and will not relight until the water flow recommences.

Tilt switch

In the event that the appliance is moved during operation or is being operated on an unstable or non-solid surface the appliance will shut down and must be switched off until a suitable surface is located.

Fuse protection

Fuses are located in the cigarette lighter and pump power inlet. In the event of an electrical supply issue these will blow and protect the electronic system of the appliance.

Unit must be stored in a clean dry place when not in use. Do not leave gas connected when storing appliance.

Appliance must only be serviced by an approved person
Please contact:

CBService@adventureoperations.com or 1300 555 197

Important: During operation ensure that all air inlets and exhausts are kept free from obstructions and closure.

SAFE LOCATIONS

This appliance shall only be used in an above ground open air situation with natural ventilation, without stagnant areas, where gas leakage and products of combustion are rapidly dispersed by wind and natural convection.

Any enclosure in which the appliance is used shall comply with one of the following:

An enclosure with walls on all sides, but with no overhead cover (see example 1).

Within a partial enclosure that includes an overhead cover and no more than two walls (see examples 2 & 3)

Within a partial enclosure that includes an overhead cover and more than two walls, the following shall apply:

at least 25% of the total wall area is completely open.
30% or more in total of the remaining wall side, back and front wall areas is open and unrestricted
(see examples 4 & 5).

In the case of balconies, 25% or more of the total wall area shall remain open and unrestricted.

DIAGRAMMATIC REPRESENTATION OF OUTDOOR AREAS

The following examples are diagrammatic representations of outdoor areas. Rectangular areas have been used in these examples - the same principles apply to any other shaped area.

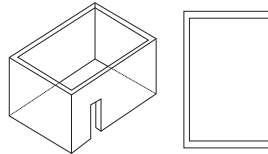

Example 1

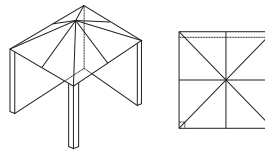

Example 2

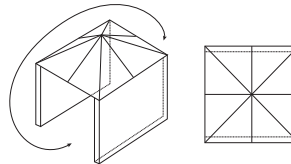

Both ends open

Example 3

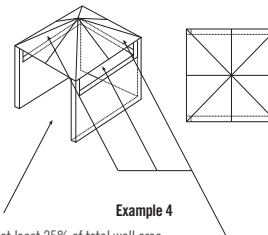

Example 4

Open side at least 25% of total wall area.

30% or more in total of the remaining wall area is open and unrestricted.

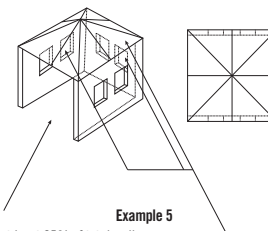

Example 5

Open side at least 25% of total wall area.

30% or more in total of the remaining wall area is open and unrestricted.

UNDERSTANDING YOUR APPLIANCE

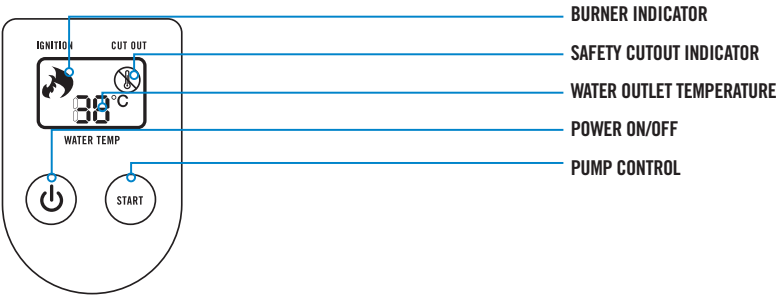
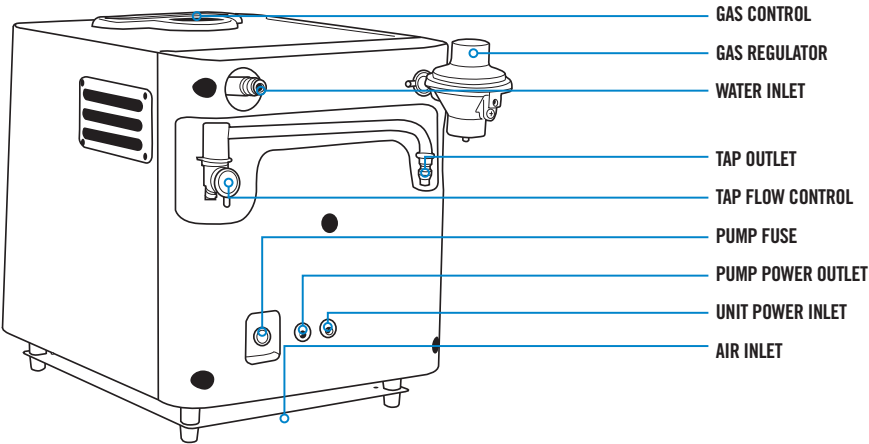
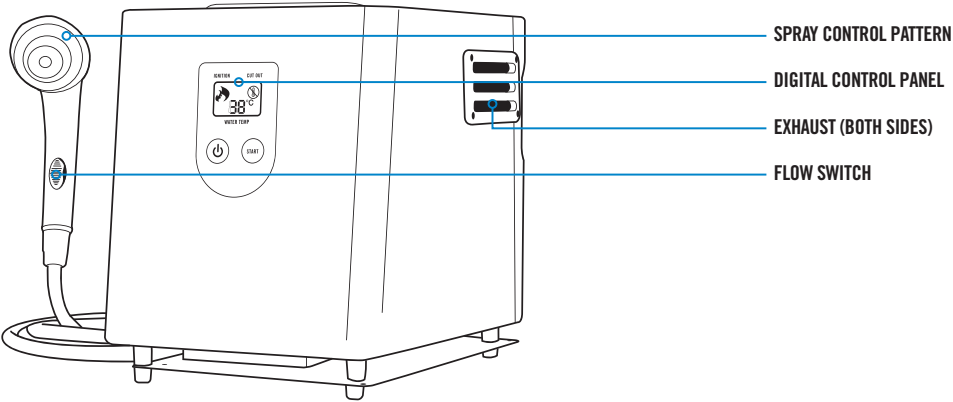

SETTING UP

Step 1. Remove all components from the storage bag and place the appliance on a solid, non-combustible surface and straighten out all hoses to remove any kinks or twists.

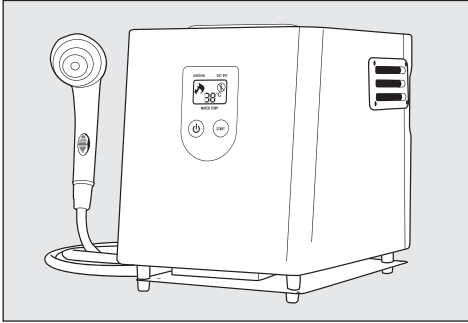

Step 2. Connect the DC power lead to the unit and the cigarette lighter fitting to a suitable DC power source.

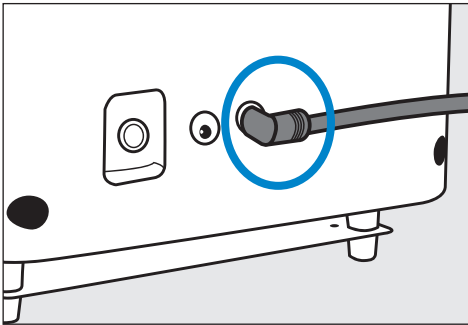

Step 3. Swing the tap away from its storage position and locate towards the side of the appliance. Check that the flow is set to maximum.

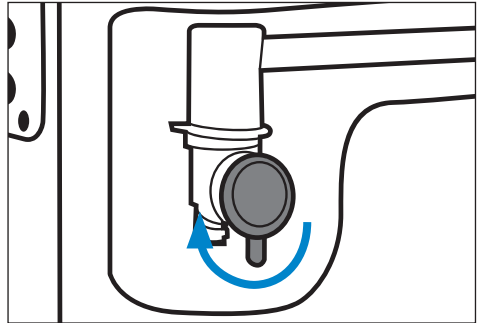
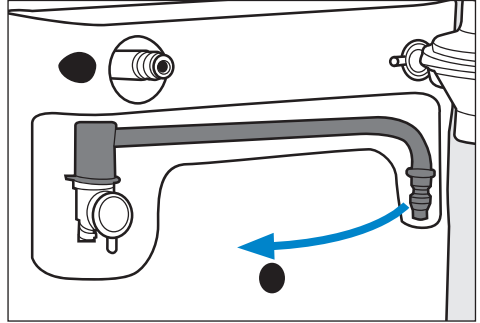

Step 4. Check that the power switch is OFF then connect the pump assembly to the water inlet and the power lead to the outlet marked PUMP.

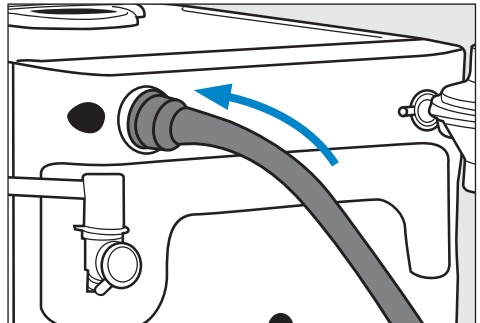

Step 5. Attach the Propane cartridge to the regulator by rotating in a clockwise direction then attach the regulator to the Aquacube[®]. Check for gas leaks with soapy water – do not use a flame. If a leak is detected remove the gas cartridge and retighten all connections, then retest.

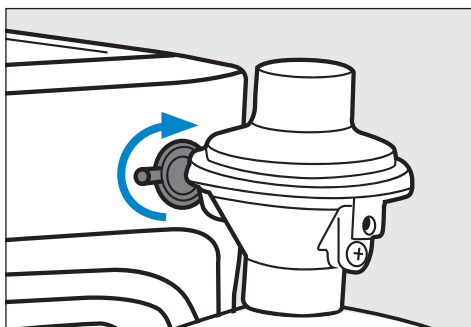
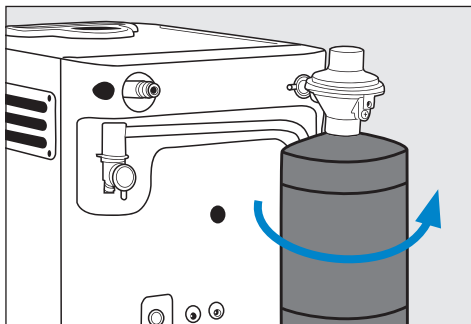

Step 6. Submerge the pump in a suitable reservoir of water, do not use water direct from rivers, lakes or the ocean. Do not use salt water with this appliance.

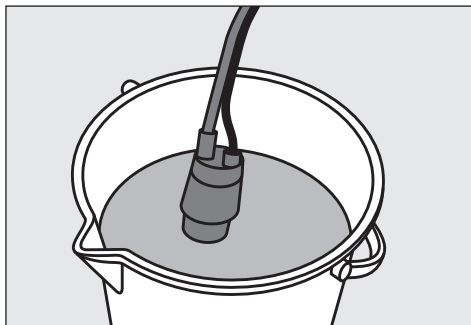

OPERATING THE SHOWER

Step 1. Press the power button and the unit will switch on.

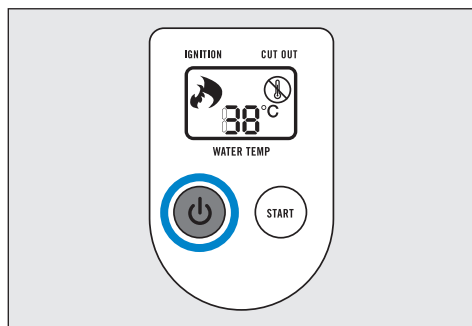

Step 2. Attach the shower hose using the quick connect fitting, and ensure that the flow switch on the shower head is in the ON position.

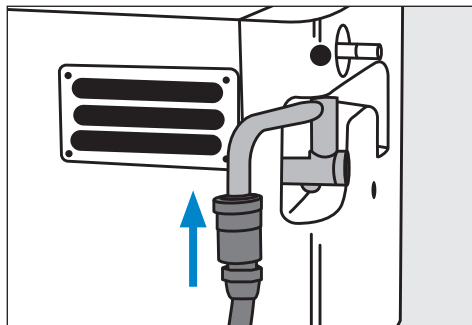

Step 3. Position the gas control in the central position, then depress the START button, water will start to flow within a few moments.

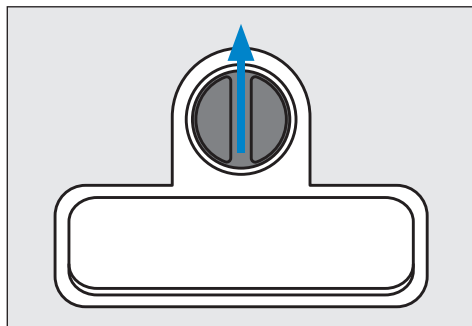

Step 4. The electronic ignition should be heard igniting the burner, when lit, the flame icon on the display will illuminate and the outlet water temperature read out will increase.

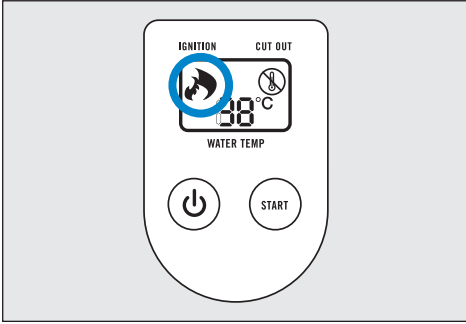

Step 5. Taking care to measure the temperature of the water from the shower head, the temperature can be adjusted by turning the gas control until the desired level is reached. Most people find water temperatures between 40-45°C comfortable for showering.

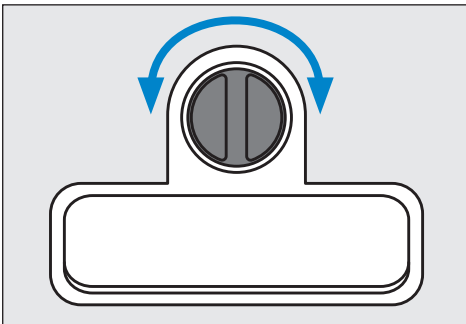

Step 6. The water flow can be stopped at any time by sliding the flow switch to the OFF position, the burner will extinguish and the pump will continue to operate.

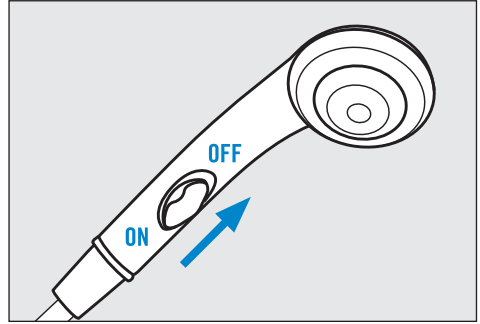

Step 7. To reignite the burner, slide the flow switch to the ON position and water will flow from the shower head and the burner will reignite within 5 to 10 seconds.

IMPORTANT

Water remaining in the heat exchanger while the flow is stopped may become hot. When the flow is resumed the user must check the temperature output to ensure that it is suitable and not too hot.

Step 8. Once the user has finished with the appliance, slide the flow switch to the OFF position and depress the START button to stop the flow of water to the appliance.

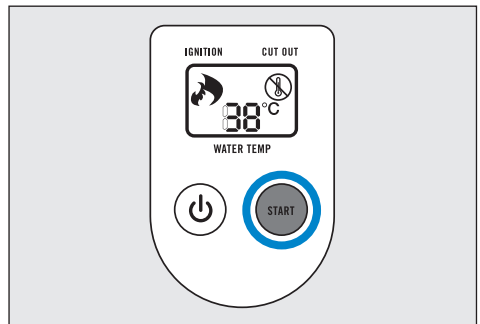

OPERATING THE TAP

Step 1. Swing the tap away from its storage position and locate towards the side of the appliance and locate a basin or bucket beneath and locate the water flow to the central position.

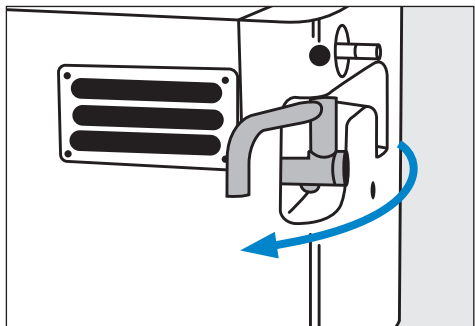

Step 2. Press the power button and the unit will turn on.

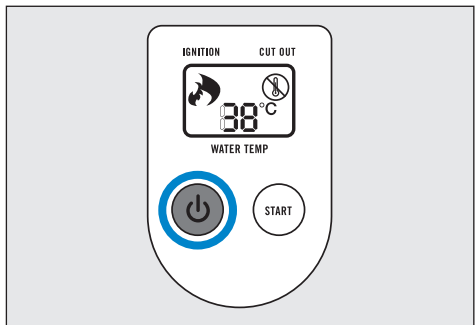

Step 3. Position the gas control in the HIGH position, then press the START button, water will start to flow within a few moments.

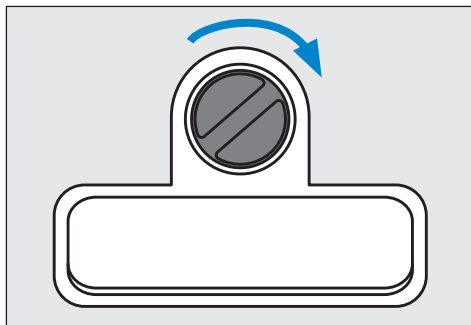

Step 4. The electronic ignition should be heard igniting the burner, when lit the flame icon on the display will illuminate and the outlet water temperature read out will increase.

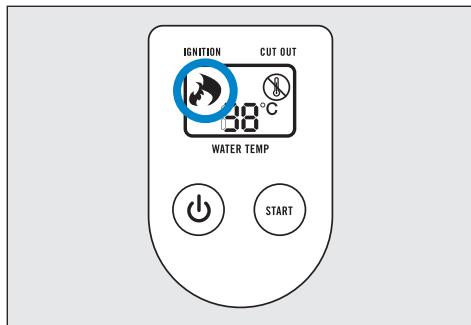

Step 5. The water temperature can be adjusted by moving the flow valve between MIN and MAX as this will slow or increase the water flow resulting in an increase or decrease in the outlet temperature.

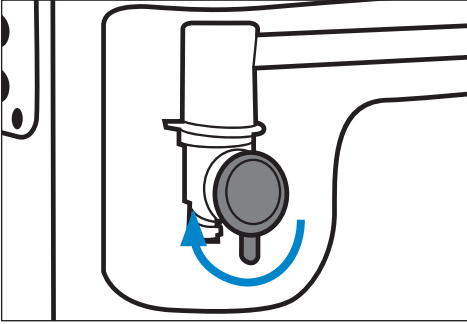

STORING THE APPLIANCE

Step 1. Press the Power button and turn the appliance off.

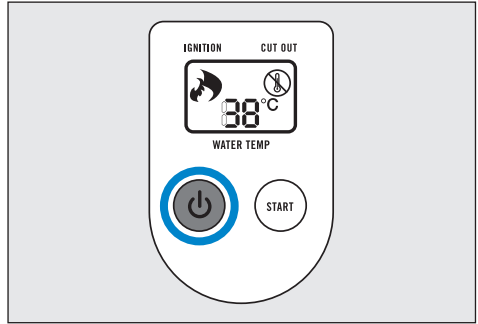

Step 2. Disconnect all hoses and hold vertically allowing all excess water to drain from them. Check that the shower head flow switch is in the ON position.

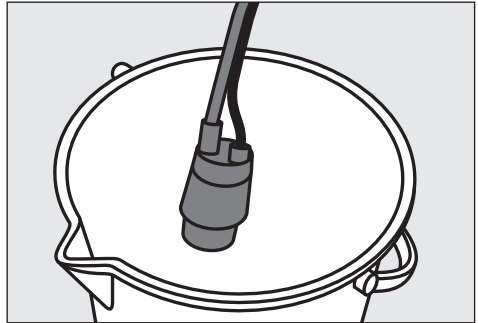

Step 3. Unscrew the regulator assembly from the appliance and remove the gas cartridge.

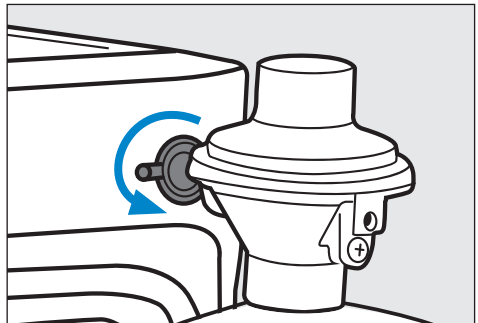

Step 4. Return the tap to its locked position.

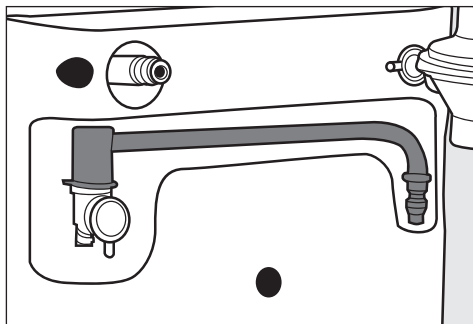

Step 5. Tip the appliance towards the back and to one side to drain excess water from the heat exchanger via the water inlet.

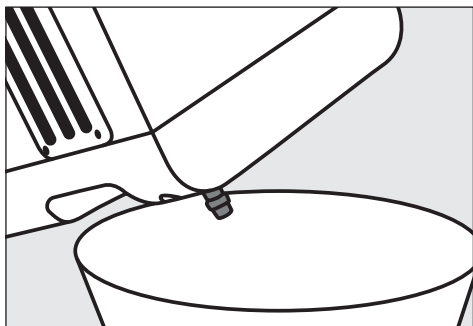

DISCONNECTING CARTRIDGE

Step 1. Check that the appliance is fully extinguished and turned off and all surfaces are cool.

Step 2. Loosen the regulator connection to the appliance in an anti-clockwise direction.

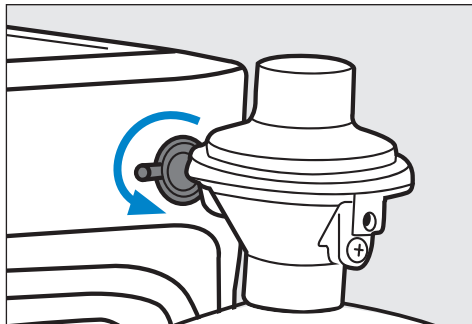

Step 3. Loosen the regulator connection to the gas cartridge in an anti-clockwise direction.

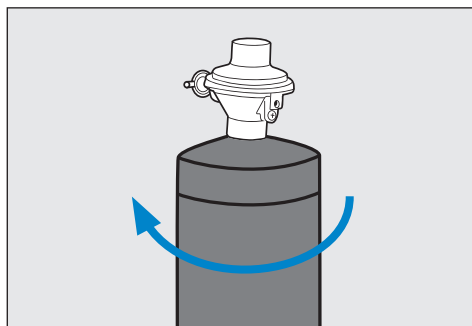

HINTS AND TIPS

Recycle water – Increased heat output

If the outlet water temperature is insufficient, it is recommended to increase the temperature by pre-heating the water before using the shower. Operate the appliance as normal and cycle the water back into the water reservoir to raise the temperature then use this for the shower.

Additionally if the smaller inner rings on the shower head are used this will contribute to increasing the water temperature.

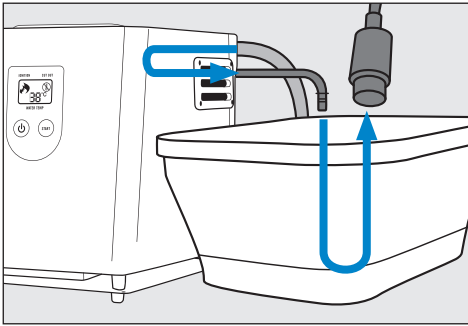

Water filter – Pump

The pump is fitted with a mesh filter on the water inlet, this must be periodically checked and cleaned if there is a build up of foreign material that may restrict the water flow to the appliance.

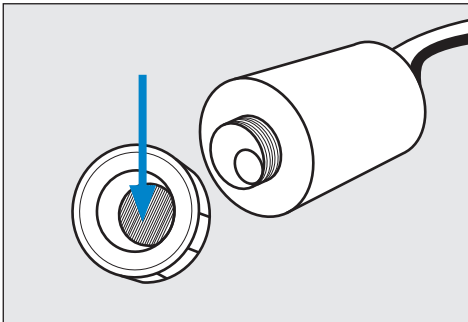

Air lock – Hoses

During operation if the water reservoir is low on water or the pump is lifted out this will result in air being sucked into the hose causing a blockage. If this occurs simply turn the appliance off, disconnect the hose and remove from the water and allow to drain out. Reassemble and commence operation.

Spray patterns – Shower head

The shower head can be adjusted to provide three distinct spray patterns. Adjust the selector dial to choose between patterns.

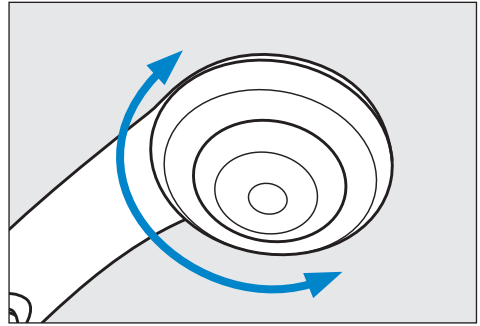

Cartridge freezing

When using the disposable cartridge and the appliance is run on high for extended periods of time the cartridge will start to freeze up - this is identified by the build up of ice on the outside of the cartridge.

This will result in reduced performance for the burners and a drop in outlet temperature.

To correct, turn the appliance to low or OFF and wait for the cartridge to return to normal appearance.

CARE INSTRUCTIONS

Using warm soapy water with a mild detergent wipe down all surfaces and areas of the appliance, taking care not to allow water to enter the burner outlets.

Do not submerge the appliance in a sink or bowl.

Do not use abrasive cleaners or bleach.

TROUBLESHOOTING

This guide should be followed in case of failure of the appliance to operate correctly.

If symptoms persist contact Customer Service on 1300 555 197.

Do not attempt to repair or modify the appliance.

Water will not flow from the shower head.	Check that appliance is switched on.
	Check sufficient water is available.
	Check that the pump is connected to the appliance.
	Check that adequate DC power is available.
	Check DC fuse in cigarette lighter fitting
Burner will not light.	Check that the water flow switch on shower head is in the ON position.
	Check that gas cylinder is turned on and that there is gas in cylinder.
	Check that water is flowing from the shower head.
	Check that the water is not over temperature.
Water is not hot enough	Check gas control.
	Check source water temperature.
	Cycle the water through the system back in to the source reservoir then through the appliance again.

ERROR CODES

The appliance is fitted with a number of operational and safety features that can be identified by the following error codes in the event that the unit will not operate:

E3: Burner Not Lit - Check gas is connected

E6: Over Temp - Turn gas to low

E7: Outlet Water Exceeds 52°C - Turn gas to low

E8: Tilt Switch Activated - Check Shower is sitting Level

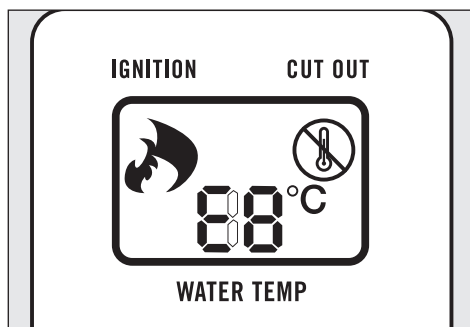

SPECIFICATIONS

Part no.	COMP812AN
Model no.	Aquacube® Digital
Ignition	Automatic
Inlet voltage	12V DC - 5A
Gas type	Propane BOM cartridge (not included)
Gas consumption	20.68 MJ/h, 412 g/h at 100% heat output
Injector size	0.66 mm x 4
Temperature lift	*30°C above source water
Max. temperature	50°C
Flow rate	2.5 - 2.5 L per minute
DC power cord length	5 m
Shower hose length	2 m
Pump hose length	1.5 m
Dimensions	245L x 310W x 300H mm
Weight	6.0 kg excluding cartridge

*Water source can be increased by up to 30°C (to a maximum of 50°C)

Requires 12V DC power source.

NOTES

This image shows a single sheet of white paper with horizontal ruling lines. The lines are evenly spaced and run across the width of the page. There are no margins, text, or other markings on the paper.

WARRANTY POLICY

1. Products distributed by Adventure Operations Australia Pty Ltd and any of our subsidiaries come with guarantees that cannot be excluded under the Australian Consumer Law. You are entitled to a replacement or refund for a major failure and compensation for any other reasonably foreseeable loss or damage. You are also entitled to have the goods repaired or replaced if products fail to be of acceptable quality and the failure does not amount to a major failure.
2. In addition, we warrant that this product will be free from defects in materials and workmanship under normal use as described in the published product documentation for 12 months from the date of original purchase (Limited Warranty). This Limited Warranty is only valid and enforceable in Australia and will apply only if you have purchased the product from us or our authorised resellers.
3. To the extent permitted by the Australian Consumer Law and any applicable local law:
 - (a) our obligations under this Limited Warranty are limited to the repair, replacement or refund of covered parts that prove defective under normal use during the Limited Warranty and does not extend to any claim for damages that you or any other person may have for any loss (including without limitation consequential damages or loss of profit, freight/shipping or travel costs), or damage howsoever caused whether or not such loss or damage arises as a result of any defect in the product or from the failure or omission on our part to comply with any obligation at law;
 - (b) in replacing a defective product under the Limited Warranty, we may, at its discretion, substitute a model of equivalent nature where the exact model is unavailable;
 - (c) this Limited Warranty does not apply to damage caused by failure and damage caused by improper use and abuse, fair wear and tear, accidents, misuse (including failure to follow instructions regarding care and maintenance of the product), neglect, disassembly, alterations or external causes such as, but not limited to, water damage, exposure to sharp objects, exposure to excessive force, anomalies in the electrical current supplied to the product (if applicable), and extreme thermal or environmental conditions;
 - (d) we may elect, at our discretion and as an alternative to repairing or replacing a defective part to refund the cost of the relevant product upon it being returned to us; and
 - (e) this Limited Warranty does not extend to any products acquired for the purposes of re-supply, or for use in a manufacturing, or repair processes.
4. This warranty may be claimed by:
returning the product to its place of purchase, with a detailed proof-of-purchase clearly showing the date and detail of the purchase;
5. If you have any questions concerning this warranty policy, you may contact us in writing:
Adventure Operations, 71 Charles Ulm Place, Eagle Farm, 4009 QLD, or by email: service@adventureoperations.com
or visit our website: www.adventureoperations.com

TO THE EXTENT PERMITTED BY LAW, ADVENTURE OPERATIONS AUSTRALIA PTY LTD, ITS SUBSIDIARIES AND ITS VENDORS DISCLAIM ANY IMPLIED WARRANTIES OF MERCHANTABILITY OR FITNESS FOR A PARTICULAR PURPOSE OR ANY SIMILAR STANDARD IMPOSED BY APPLICABLE LEGISLATION AND ADVENTURE OPERATIONS AUSTRALIA PTY LTD AND ITS SUBSIDIARIES' RESPONSIBILITY TO REPAIR, REPLACE, OR OFFER A REFUND FOR DEFECTIVE PRODUCTS IS THE SOLE AND EXCLUSIVE REMEDY PROVIDED TO ITS CUSTOMERS UNDER THIS DOCUMENT.

WARRANTY - For details see www.companionleisure.com.au/warranty

Companion[®] is a registered trademark of

Primus Australia Pty Ltd

Designed & Imported by:

Adventure Trading Australia Pty Ltd

71 Charles Ulm Place,

Eagle Farm, QLD 4009

AUSTRALIA

Made in China

